

EMBRACING MITHI

Making Ignorance Transform into Harmonious Identity

Water had a sense of tangibility and sanctity in the socio-cultural spaces. Today, it is being regulated through metered pipelines, run through concretized embankments and treated by the machines of governance. The 4-6m high concrete retaining walls along the edges of the river have physically barred people from its access while impairing the visual connect; Making Mithi the 'backyard of the city'. **The thesis focuses on a new routine of resilient coexistence of nature and people, where minimum water standards are maintained by the stakeholders themselves. It imagines the interface between the river and the city as a public realm, that merges the institutions of employment with that of learning and pleasure; transforming Mithi from backyard to front yard of the city.** The response looks at Mithi river through a lens of six narratives. The city scale deals with conservation of the river's catchment and its reconnect to the city. While the site, Filterpada, allows to use the existing Water Filtration Plant as a tool in dissecting the hegemonic control over water as a resource (diagonal basalt walls), leading to the creation of an **Ecological Awareness Institution**. The processes related to water purification now become open to the city as a laboratory; Where hydrological and soil research become a part of citizen participation workshops, integrated with the residential school. A space where bioengineered methods interweave to form a self-sustaining model of learning through reflection on reconnecting with the Urban river. **Keywords: River Revival, Conservation, Ecology**

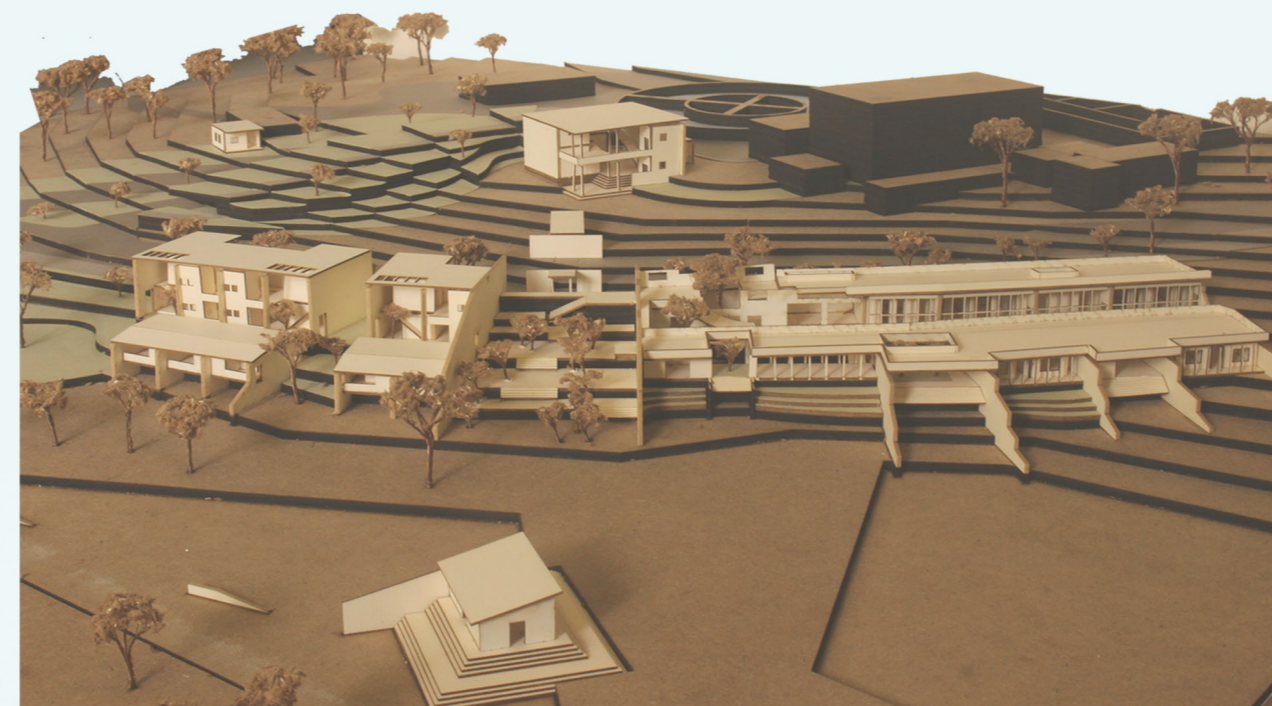
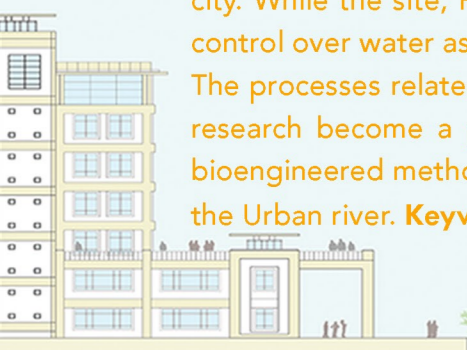

VIEW OF ECOLOGICAL AWARENESS INSTITUTION

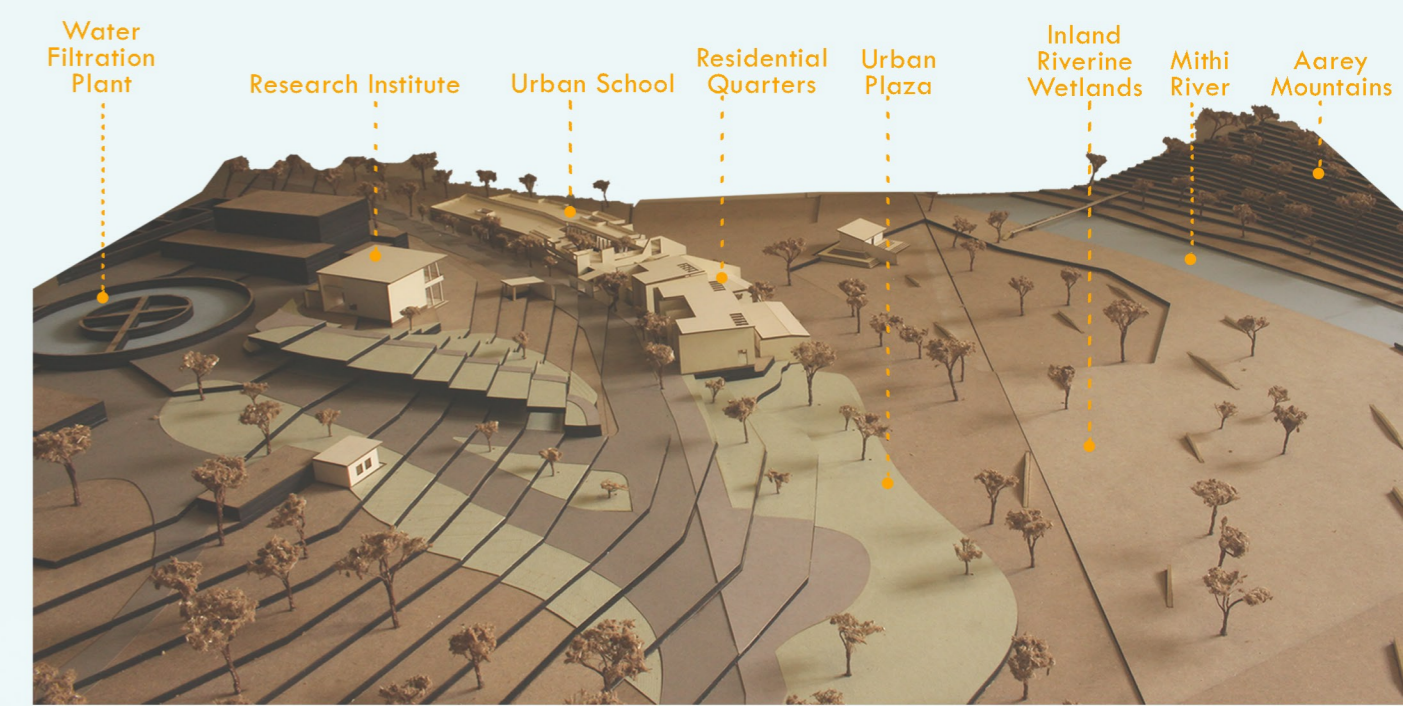

THE DIAGONAL CONNECT ACROSS MITHI RIVER

